



Malham Grove, York

£395,000

**Stephensons**  
estate agents & chartered surveyors

[stephensons4property.co.uk](http://stephensons4property.co.uk)

# S

Malham Grove,  
York YO31 0QG

Est. 1871

£395,000

Beautifully presented to an exceptional standard throughout, this stunning three-bedroom semi-detached home has been extended and upgraded to create a stylish and versatile family home, perfectly suited to modern living. Finished to a high standard throughout, the property offers spacious and versatile accommodation both inside and out.

At the heart of the home lies the impressive open-plan kitchen and dining space. Finished to a high specification, the kitchen features elegant quartz worktops, a range of integrated appliances and ample storage, providing a great space for both everyday family life and entertaining. The skylight and bi-fold doors flood the room with natural light, creating a bright and airy feel throughout, while seamlessly connecting the indoor and outdoor living spaces. The kitchen is complemented by a utility room and ground floor WC.

Complementing the open-plan kitchen is a welcoming separate living room positioned to the front of the property. Featuring a charming bay window and attractive log-burning stove.

The first floor benefits from three good sized bedrooms, all presented to a high standard, These are served by a stylish and well presented family bathroom.

Externally, the property enjoys a beautifully presented rear garden designed with both relaxation and entertaining in mind. A particular feature is the former garage, which has been



Tenure: Freehold  
Services/Utilities: All mains services connected.  
EPC Rating: D  
Council Tax: - C  
Current Planning Permission: Planning permission for the converted garage to a beauty salon.

Imagery Disclaimer: Some photographs and videos within these sales particulars may have been digitally enhanced or edited for marketing purposes. They are intended to provide a general representation of the property and should not be relied upon as an exact depiction.

\*Download speeds vary by broadband providers so please check with them before purchasing.



professionally converted into a fully functioning hair salon with the benefit of planning permission in place. This highly versatile space offers an excellent opportunity for those wishing to operate a business from home.

To the front, a double-width driveway provides ample off-street parking. Situated within easy reach of a wide range of local amenities, highly regarded schools and excellent transport links, this outstanding home offers the perfect balance of style, practicality and convenience. Finished to an impressive standard throughout.

## Partners:

J F Stephenson MA (Cantab) FRICS FAAV  
 I E Reynolds BSc (Est Man) FRICS  
 R E F Stephenson BSc (Est Man) MRICS FAAV  
 N J C Kay BA (Hons) pg. dip MRICS  
 O J Newby FNAEA  
 J E Reynolds BA (Hons) MRICS  
 R L Cordingley BSc FRICS FAAV  
 J C Drewniak BA (Hons)  
 E G Newby MRICS  
 T Brooks MNAEA

## Associate Partners:

N Lawrence  
 I Jarvis MNAEA

York: 01904 625533  
 Boroughbridge: 01423 324324  
 Easingwold: 01347 821145  
 Selby: 01757 706707  
 Haxby: 01904 809900

## Malham Grove, York, YO31 0QG

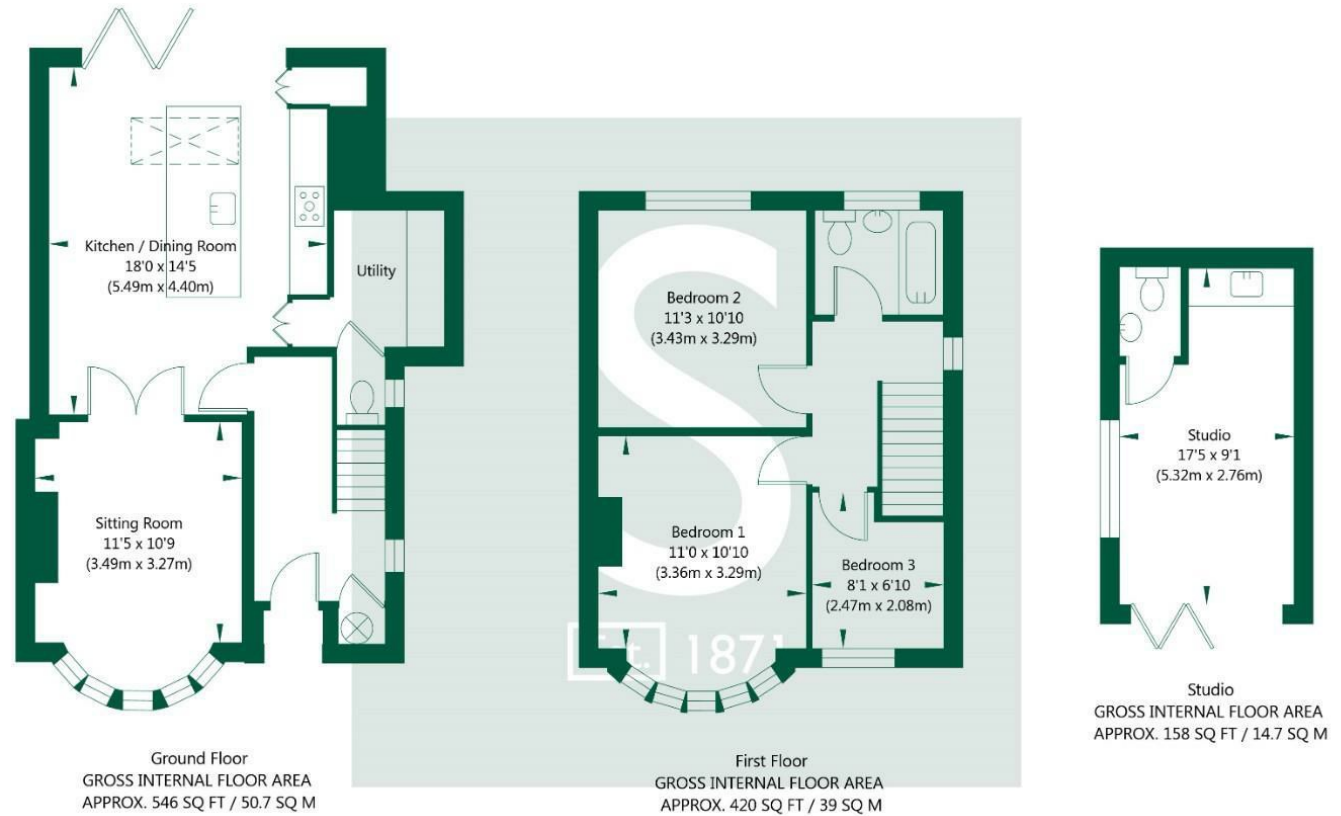

NOT TO SCALE - FOR ILLUSTRATIVE PURPOSES ONLY  
 APPROXIMATE GROSS INTERNAL FLOOR AREA 1124 SQ FT / 104.4 SQ M  
 All measurements and fixtures including doors and windows are approximate and should be independently verified.  
 www.exposurepropertymarketing.com © 2026

