



Stillington, York

£1,100,000

Stephensons
estate agents & chartered surveyors

stephensons4property.co.uk

S

York YO61 1LY

Est. 1871

£1,100,000

An outstanding 5 bedroom detached family home set within gardens and grounds of around 1.5 acres on the rural fringes of Huby and Stillington, yet only 7.5 miles north of York. Extending to over 3,680 sq ft (342 sq m) of highly versatile living space, this impressive individually designed property also comes with generous parking and an integral double garage.

A spacious 25' (7.77m) long reception hall leads off into a well proportioned study and a charming snug featuring oak flooring and delightful rural views. The superb 24'3" (7.10m) long sitting room provides an elegant yet comfortable space, centred around a stunning open fireplace with a granite hearth and double doors opening directly onto the garden.

At the heart of the home lies a truly exceptional 35'1" (10.7m) long open plan dining kitchen and living room. This remarkable space is fitted with expansive granite worktops and an extensive range of storage units, complemented by a substantial central island with breakfast bar. A walk-in pantry and a suite of integrated appliances, including a dishwasher, american style fridge freezer, induction hob, microwave, double oven and 2 warming drawers further enhance the kitchen's appeal. The living area is equally impressive featuring a wood-burning stove and two sets of bi-fold doors opening onto the rear garden, seamlessly blending indoor and outdoor living.

The ground floor also benefits from a cloakroom/WC, a practical utility room with electric cooker, sink and space for a washer and dryer and an outstanding boot room with its own external access from the driveway. This space also provides internal access to the integral double garage with electric roller doors and features a striking spiral staircase leading to a superb 359 sq ft (33.35 sq m) studio with oak flooring and an impressive 9'11" (3.02m) vaulted ceiling. This highly flexible space is



Tenure: Freehold
Services/Utilities: Electricity, Water and Sewerage are understood to be connected
Broadband: Up to 21 Mbps* download speed
EPC Rating: 68 - D
Council Tax: G - North Yorkshire Council
Current Planning Permission: No current valid planning permissions

*Download speeds vary by broadband providers so please check with them before purchasing.



ideal as a games room, home office, gym or additional sitting room.

Upstairs, a spacious landing leads to a truly stunning 35'0" (10.66m) long principal bedroom suite featuring exposed beams, generous dressing area, Juliet balcony offering far reaching countryside views and a luxuriously appointed en-suite bathroom complete with underfloor heating, contemporary washstand, large bath and a separate walk-in dual-head shower. The first floor also includes a guest bedroom with en-suite shower room, 3 further well proportioned bedrooms and a family bathroom featuring both a bath and separate walk-in shower.

Further internal features include oil-fired radiator central heating, double glazing and oak doors throughout.

Externally, the property is approached via a gated private driveway providing ample parking and access to the integral double garage. The formal gardens and grounds extend to approximately 0.70 of an acre and are beautifully arranged with lawns, pathways and multiple paved seating areas. In addition, the grounds include vegetable and soft fruit gardens, wildflower areas and an orchard with apple, pear, plum, and cherry trees. A gated entrance leads to an adjoining paddock of around 0.80 acres. This property is also registered as a smallholding, making it perfectly suited to those seeking a more self-sufficient or rural lifestyle.

AGENTS NOTE

Imagery Disclaimer: Some photographs and videos within these sales particulars may have been digitally enhanced or edited for marketing purposes. They are intended to provide a general representation of the property and should not be relied upon as an exact depiction.

DON'T MISS OUT ON YOUR NEXT HOME

Last year, our social media content reached over 6.7 million views. By following Stephenson's, you'll get exclusive video content, pre-market property teasers, off-market opportunities and early access to new listings before they appear online. Follow us today and stay one step ahead of other house hunters. Simply search @stephenson's1871 on your favourite social media platform and start exploring.

Partners:

J F Stephenson MA (Cantab) FRICS FAAV
 I E Reynolds BSc (Est Man) FRICS
 R E F Stephenson BSc (Est Man) MRICS FAAV
 N J C Kay BA (Hons) pg. dip MRICS
 O J Newby FNAEA
 J E Reynolds BA (Hons) MRICS
 R L Cordingley BSc FRICS FAAV
 J C Drewniak BA (Hons)
 E G Newby MRICS
 T Brooks MNAEA

Associate Partners:

N Lawrence
 I Jarvis MNAEA

York: 01904 625533
 Boroughbridge: 01423 324324
 Easingwold: 01347 821145
 Selby: 01757 706707
 Haxby: 01904 809900

Stillington, York, YO61 1LY

Ground Floor - (Excluding Garage)
 GROSS INTERNAL FLOOR AREA
 APPROX. 1829 SQ FT / 169.94 SQ M

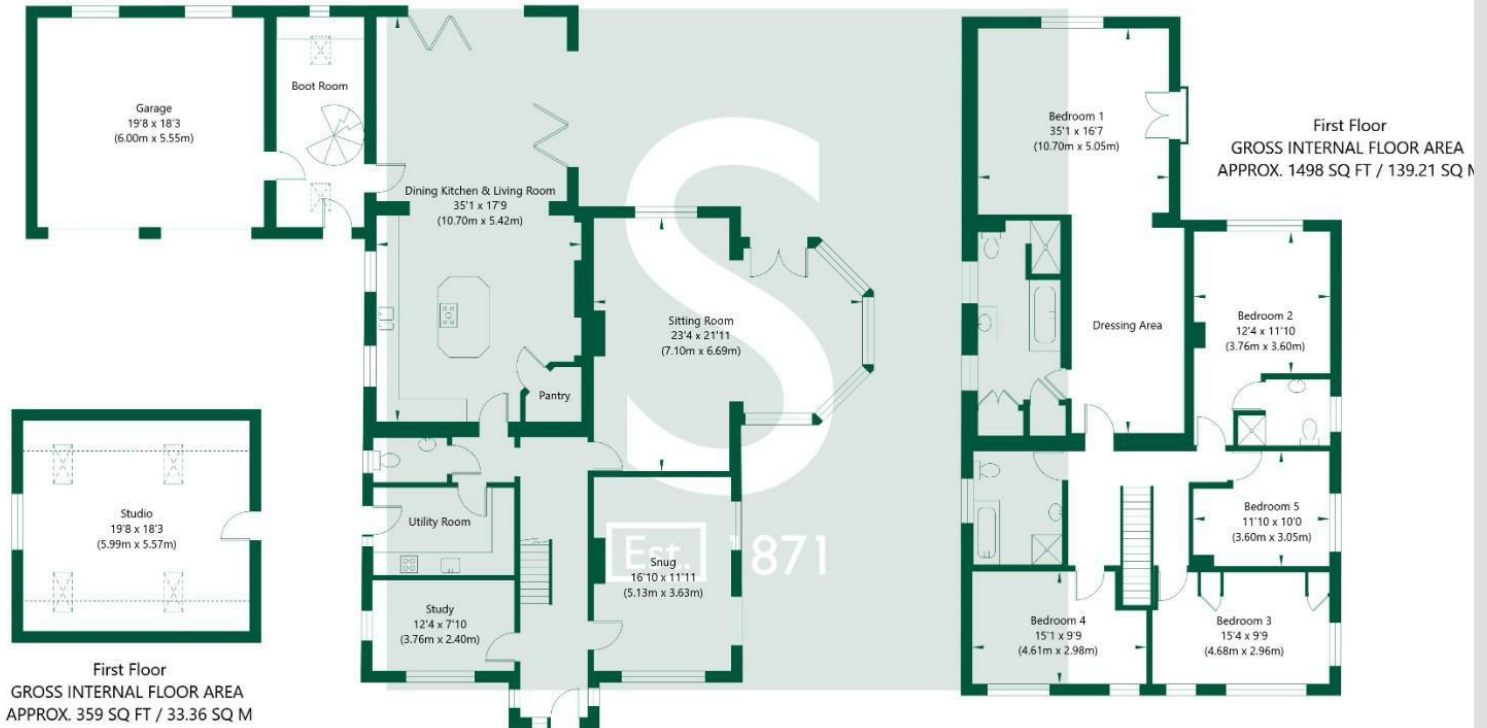

NOT TO SCALE - FOR ILLUSTRATIVE PURPOSES ONLY
 APPROXIMATE GROSS INTERNAL FLOOR AREA 3686 SQ FT / 342.51 SQ M - (Excluding Garage)
 All Measurements and fixtures including doors and windows are approximate and should be independently verified.
www.exposurepropertymarketing.com © 2026

